

Landscape Notes:

- All trees shall be provided as container grown trees.
- Replacement of dead landscaping shall occur within 90 days of notification. replacement material must be of similar character as the dead landscaping. Failure to replace dead landscaping, as required by the zoning official or his or her designee, shall constitute a violation of this article subject to the general penalty provisions of City Code section 1-14
- The property owner is responsible for regular weeding, mowing, fertilizing, and other maintenance of all plantings following acceptance from Contractor. The required landscaping must be maintained in a healthy, growing condition at all times.
- Plant material shown here is represented at its mature size. At the time a request for a certificate of occupancy is made, shrubs and hedges shall be at least three feet in height.
- Contractor is to seed all disturbed areas left unpaved and guarantee coverage of vegetation until establishment of grass. Grass type shall be Bermuda grass or Rye/Bermuda mixture.
- All water meters, hydrants, valves, manholes, and cleanouts, on or adjacent to the property, must remain accessible during construction and upon the completion of necessary grading and landscaping.
- "Cal." indicates caliper at 12" above the ground. Multi-trunk trees' caliper is measured with the single, largest cane.
- A Irrigation System is required for all landscape areas.
- To ensure the growth of trees in end islands, a minimum 24-inch soil depth and 25- cubic feet of appropriate planting medium is required per tree, with topsoil mounded to a center height.

Landscape Analysis:

Construction Activities:



Parking & Pavement	=	8,495	SF
Buildings	=	960	SF
Lime Stone Gravel Yard	=	28,000	SF
Net Total=		37,455	SF

Requirements:

Building, Parking, & Pavement	=	5,619	SF
37,455 SF @ 15%			
Net Total=		5,619	SF

Provided:

Canopy Trees	=	3,000	SF
15 @ 200 SF			
Non-Canopy Trees	=	2,800	SF
28 @ 100 SF			
Net Total=		5,800	SF

Symbol	Qty.	Common Name	Botanical Name	Size
	15	Cedar Elm	Ulmus Crassifolia	1 1/2"-3" cal.
	28	Crepe Myrtle	Lagerstroemia indica	1 1/2" cal.
		Bermuda Grass	---	Ground Cover

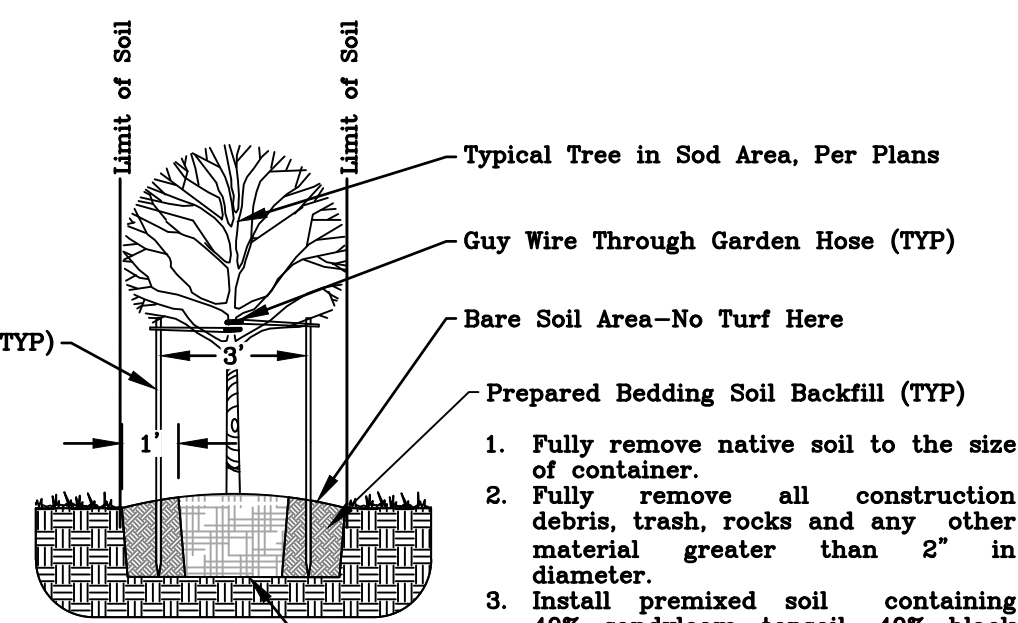

- Notes:**
- Top of root ball to be 3" higher than final grade.
 - Top of root ball to be exposed.
 - Fully remove native soil to the size of container.
 - Fully remove all construction debris, trash, rocks and any other material greater than 2" in diameter.
 - Install premixed soil containing 40% sandyloam topsoil, 40% black humus and 20% sharp sand.
 - Dig planting hole width 12" larger than rootball on all sides.
 - Scarify root ball.
 - Root flare shall be exposed.

Root Ball to Rest on Native Soil

Tree Staking & Planting
N.T.S

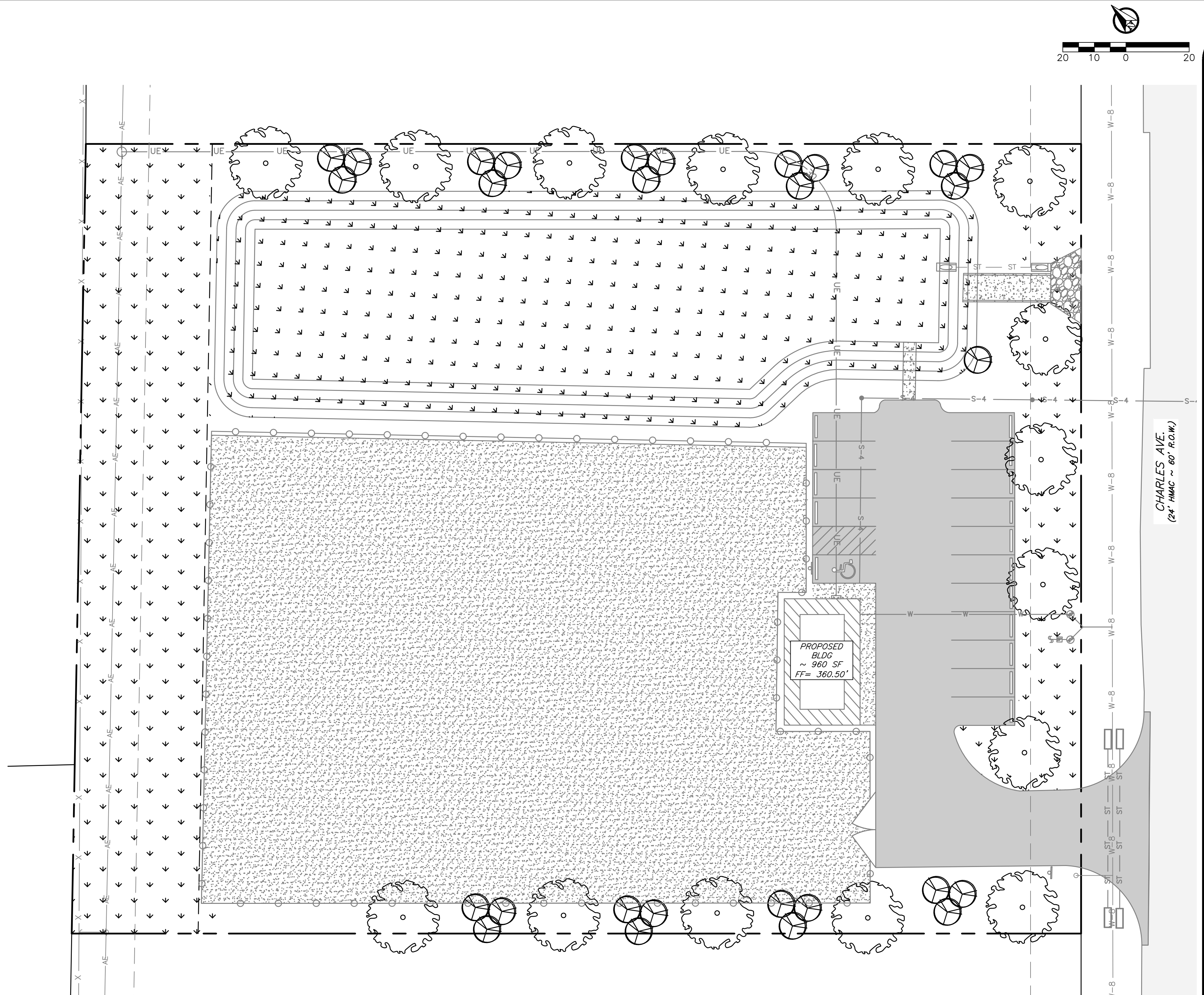

Landscape Plan

General Notes:

- It is the intent of these plans to comply with all City of Bryan guidelines, specifications, & details.
- See Sheet C1-General Notes.

No.	Revision/Issue	Date

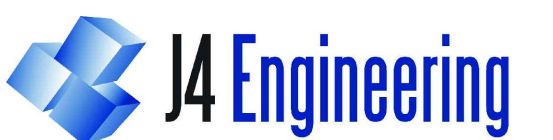
Firm Name and Address:

 PO Box 5192 - Bryan, Texas - 77805
 979-739-0567 www.J4Engineering.com
 Firm# 9951

Project Name and Address:
AMA Towing
 4031 Charles Ave.
 1.82 Acres - Lot 4, Block 1
 Parkwood Estates, 2nd Installment
 Bryan, Brazos County, Texas

Date: Feb 2022
 Scale: As Noted

Sheet:
L1